

# SERVICE MANUEL

## VITROCERAMIC COOKER 0.601

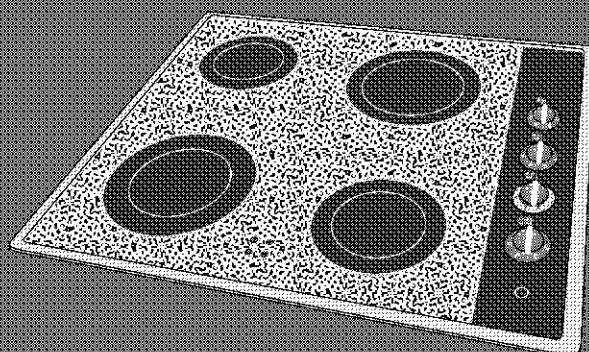



## **A T T E N T I O N !**

**For personal safety,  
make sure that the gas  
and the electrical  
connections to the range  
have been disconnected  
before starting the  
removal procedure to  
replace parts.**

## **0.601 VITROCERAMIC COOKER**

### **C O N T E N T S**

#### **0.601 Vitroceramic Cooker**

Replacement of the Knobs / 2

Replacement of the Vitroceramic glass - frame group / 2

Replacement of the leakage preventive washer / 3

Replacement of the Radian Vitroceramic Hotplate's Commutator / 3

Replacement of the Duo Vitroceramic Hotplate's Commutator / 4

Replacement of the Vitroceramic Hotplate (Radian and Duo) / 4

Replacement of the Hob Temperature Indicator Lamp / 5

Replacement of the Warning signal lamp / 5

Replacement of the terminal block / 6

Replacement of the main cable / 6

## 0.601 VITROCERAMIC COOKER

### Replacement of the Knobs

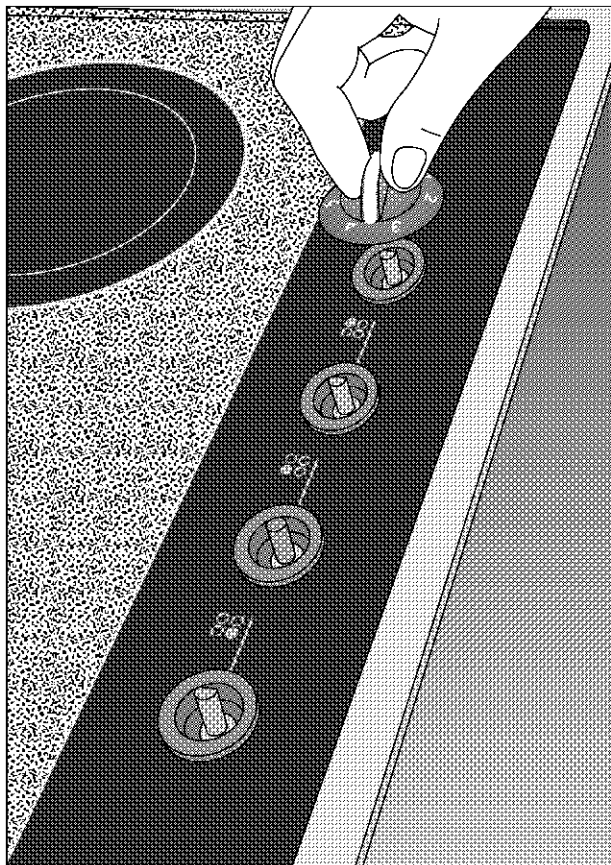

1. Remove the knobs by holding them tightly and pulling them onwards.
2. When placing the new knobs, pay attention to fit them correctly.

### Replacement of the Vitroceramic glass - frame group

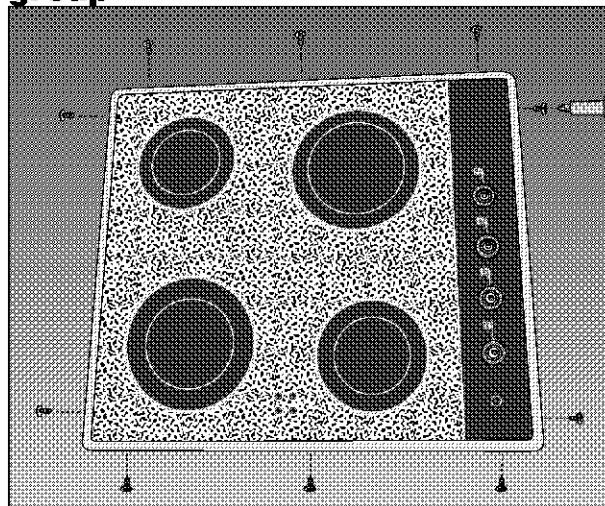

Unscrew the 12 screw that fasten the bottom protection sheet to the vitroceramic glass - frame group. Then, lift up the vitroceramic glass -frame group and replace it with a new one.

## 0.601 VITROCERAMIC COOKER

### Replacement of the leakage preventive washer

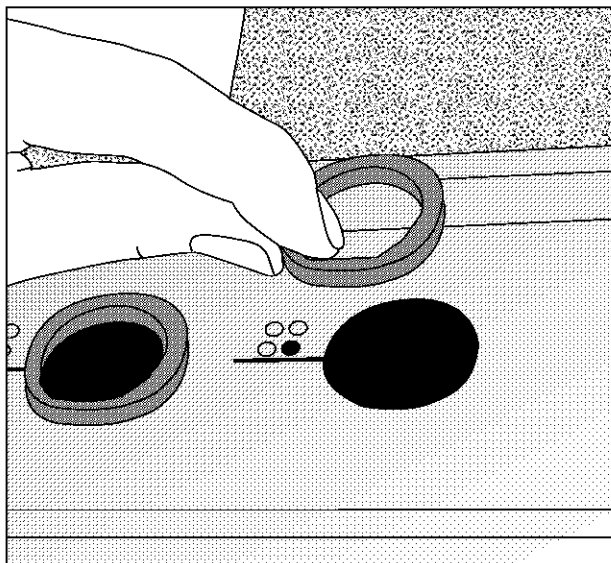

Remove the vitroceramic glass -frame group. Pull and take out the preventive washer at the bottom of the knobs on the vitroceramic glass - frame group.

### Replacement of the Radian Vitroceramic Hotplate's Rotary Switch

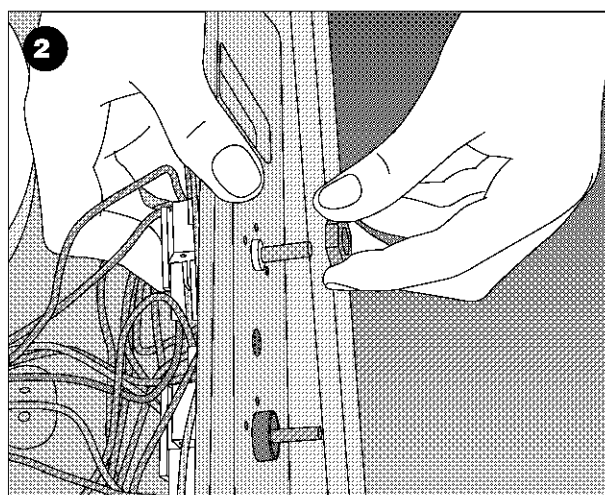
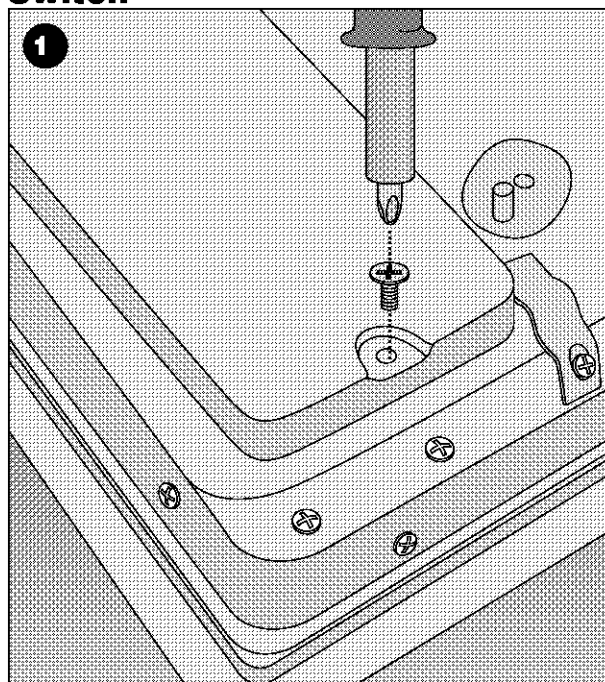

1. Turn the vitroceramic cooker upside and down prior to this operation. Then unscrew the screw of the rotary switch supporting sheet and leave the barbs on the sides of the rotary switch supporting sheet and release it. Remove the vitroceramic glass - frame group. Unscrew the four screws on the bottom of the rotary switch supporting sheet and release the sheet together with the components on it.

2. Lift rotary switch supporting sheet slightly and unscrew the nut that fasten rotary switch and release the rotary switch.

Disconnect the sockets on the rotary switch respectively and replace the radian vitroceramic hotplate with the new one. Reassemble the new rotary switch according to the electrical wiring diagram.

## 0.601 VITROCERAMIC COOKER

### Replacement of the Duo Vitroc ceramic Hotplate's Switch

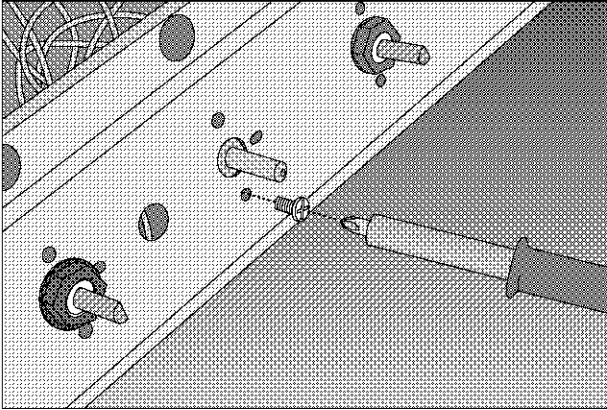

**1.** Turn the vitroc ceramic cooker upside and down prior to this operation. Then unscrew the screw of the switch supporting sheet and leave the barbs on the sides of the switch supporting sheet and release it.

Remove the vitroc ceramic glass - frame group. Unscrew the four screws on the bottom of the switch supporting sheet and release the sheet together with the components on it.

**2.** Lift switch supporting sheet slightly and unscrew the two nuts that fasten duo vitroc ceramic hotplate switch and release the switch.

Disconnect the sockets on the switch respectively and replace the radian vitroc ceramic hotplate with the new one. Reassemble the new switch according to the electrical wiring diagram.

### Replacement of the Vitroc ceramic Hotplate (Radian and Duo)

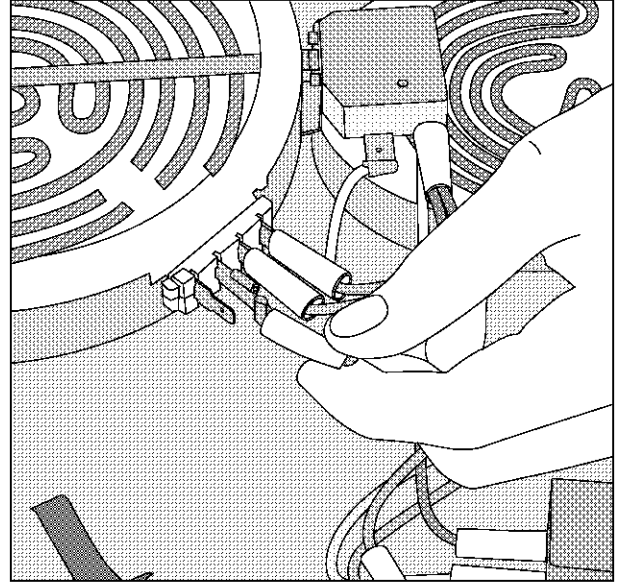

Remove the vitroc ceramic glass - frame group prior to this operation. Disconnect all the sockets on the vitroc ceramic hotplate and take the released hotplate.

Reassemble the new hotplate (radian and duo) according to the electrical wiring diagram.

## 0.601 VITROCERAMIC COOKER

### Replacement of the Hob Temperature Indicator Lamp

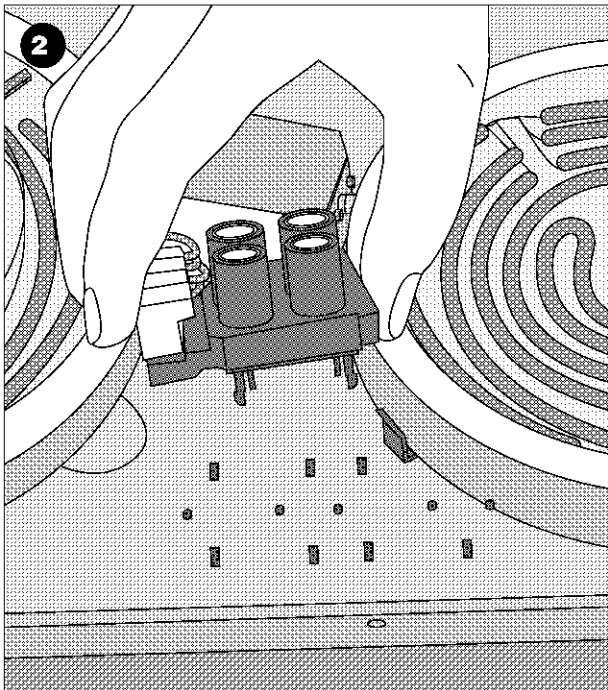
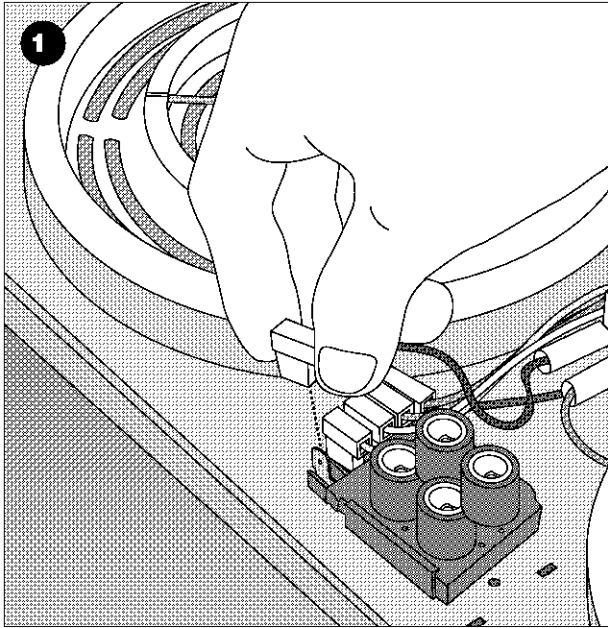

Remove the vitroceramic glass - frame group prior to this operation. Then;

1. Disconnect all the lamp sockets of the vitroceramic hotplates' temperature indicator.
2. Pull the temperature indicator lamp group upwards tightly and release it from the bottom protection sheet. Replace the hob temperature indicator lamp and reassemble the new one according to the electrical wiring diagram.

### Replacement of the Warning signal lamp

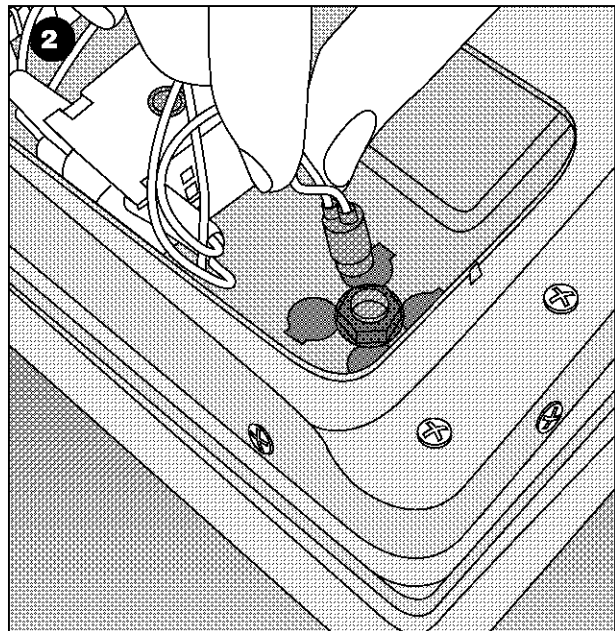
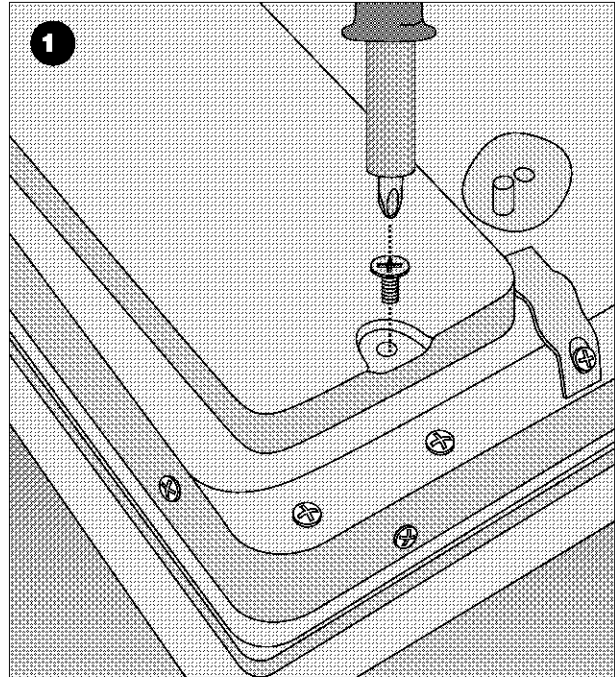

Turn the vitroceramic cooker upside and down prior to this operation. Then;

1. Unscrew the screw of the commutator supporting sheet and leave the barbs on the sides of the commutator supporting sheet and release it.
2. Disconnect the tips of the warning signal lamp connected to the signal lamp lens and hotplate commutators and replace the warning signal lamp. Reassemble the new one according to the electrical wiring diagram.



## 0.601 VITROCERAMIC COOKER

### Replacement of the terminal block

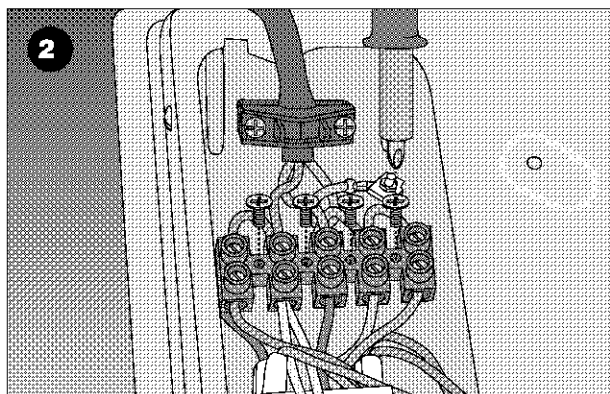
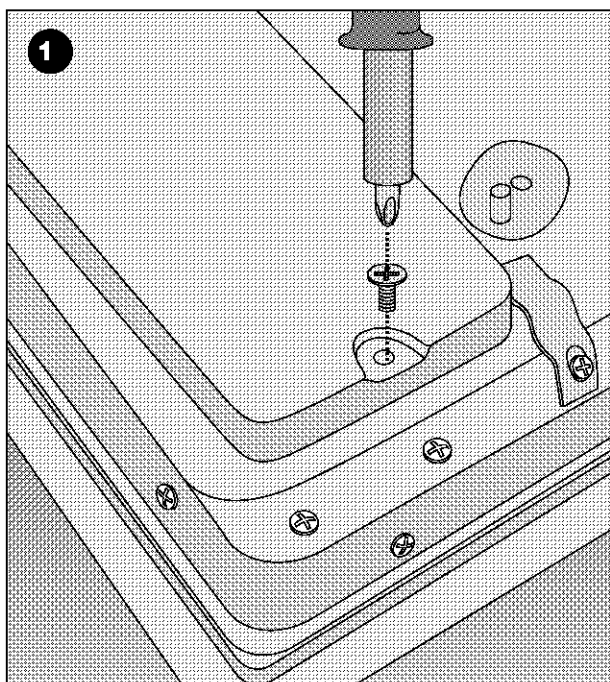

Turn the vitroceramic cooker upside and down so that the bottom protection sheet will be upwards prior to this operation. Then;

1. Unscrew the screw of the commutator supporting sheet and leave the barbs on the sides of the commutator supporting sheet and release it.
2. Unscrew the cables of the terminal block with a suitable screwdriver. After unscrewing the two screws that fasten the terminal block to the bottom protection sheet, take out the terminal block. Afterwards make all the electrical connections according to the electrical schematic diagram while replacing the terminal block with a new one.

### Replacement of the main cable

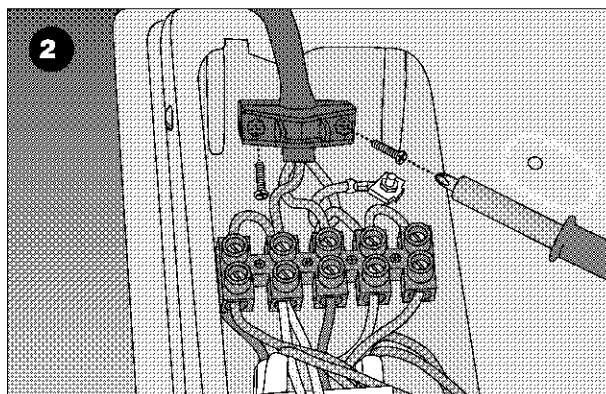
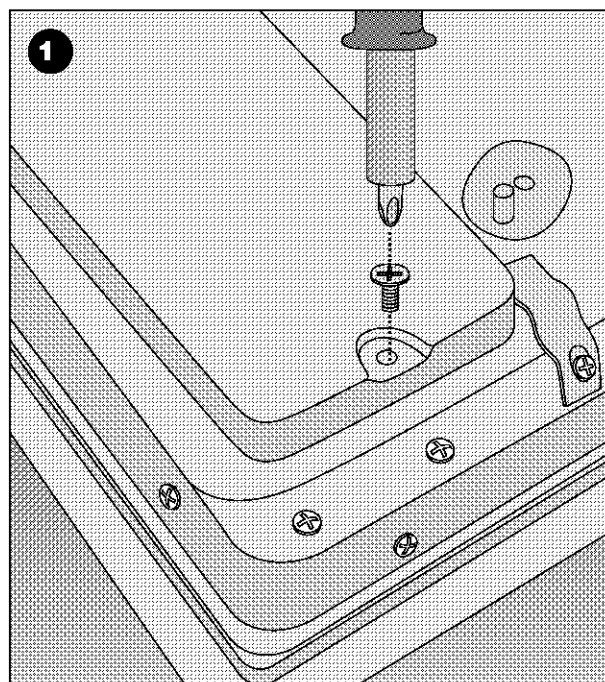

Turn the vitroceramic cooker upside and down so that the bottom protection sheet will be upwards prior to this operation. Then;

1. Unscrew the screw of the commutator supporting sheet and leave the barbs on the sides of the commutator supporting sheet and release it.
2. Unscrew the two screws that fasten the main cable's retainer to the bottom protection sheet. After unscrewing the screw of main cable grounding nut, disconnect the two cables fitting into main cable and take released main cable. Afterwards make all the electrical connections according to the electrical schematic diagram while replacing the main cable with a new one.